

Mid-Length Sockets

The GearWrench Mid-Length Socket range is designed to enhance productivity by offering greater access in difficult applications where a deep socket is necessary but is too long to give the clearance required. Both the 1/4" drive mid-length sockets and the 3/8" drive mid-length sockets are 0.7" shorter than the equivalent GearWrench deep sockets, giving this extra clearance. In addition to offering access, this line of sockets includes the features that users have come to expect from GearWrench and deliver on the brand promise of greater speed, strength and access.



Speed

- Angled entry guides the socket on to the fastener
- Full polish for easy cleaning and visibility
- Double line (SAE) & knurled line (mm) to easily identify standard versus metric sockets
- Large hard-stamped size on both sides for fast, easy identification

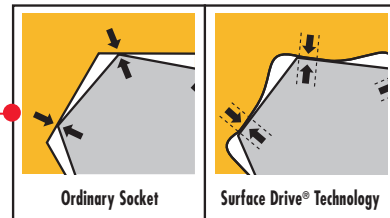

Strength

- Surface Drive® contact points virtually eliminate the rounding of fasteners



Access

- Mid-length sockets are intended for use when a standard socket is not long enough to give access, but a deep socket will not fit in the space available

Mid-Length Sockets

Mid-Length Sockets - Open Stock

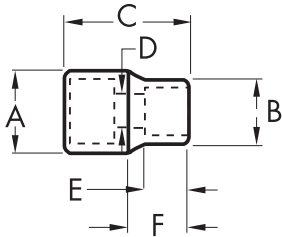

DIMENSIONAL DATA (INCHES)

| PART NO. | PRODUCT NAME | A | B | C | D | E | F | WEIGHT |
|----------|---|-------|-------|-------|-------|-------|-------|--------|
| 80115S | 1/4" Drive 6 Pt. Mid Length SAE Socket 3/16" | 0.460 | 0.300 | 1.250 | 0.120 | 0.310 | 0.640 | 0.030 |
| 80116S | 1/4" Drive 6 Pt. Mid Length SAE Socket 7/32" | 0.460 | 0.340 | 1.250 | 0.160 | 0.470 | 0.640 | 0.030 |
| 80117S | 1/4" Drive 6 Pt. Mid Length SAE Socket 1/4" | 0.460 | 0.370 | 1.250 | 0.180 | 0.510 | 0.640 | 0.030 |
| 80118S | 1/4" Drive 6 Pt. Mid Length SAE Socket 9/32" | 0.460 | 0.420 | 1.250 | 0.200 | 0.510 | 0.640 | 0.030 |
| 80119S | 1/4" Drive 6 Pt. Mid Length SAE Socket 5/16" | 0.460 | 0.460 | 1.250 | 0.200 | 0.530 | NA | 0.030 |
| 80120S | 1/4" Drive 6 Pt. Mid Length SAE Socket 11/32" | 0.500 | 0.500 | 1.250 | 0.240 | 0.530 | NA | 0.040 |
| 80121S | 1/4" Drive 6 Pt. Mid Length SAE Socket 3/8" | 0.570 | 0.570 | 1.250 | 0.300 | 0.530 | NA | 0.050 |
| 80122S | 1/4" Drive 6 Pt. Mid Length SAE Socket 7/16" | 0.550 | 0.620 | 1.250 | 0.350 | 0.570 | NA | 0.060 |
| 80123S | 1/4" Drive 6 Pt. Mid Length SAE Socket 1/2" | 0.630 | 0.700 | 1.250 | 0.390 | 0.570 | NA | 0.070 |
| 80124S | 1/4" Drive 6 Pt. Mid Length SAE Socket 9/16" | 0.710 | 0.780 | 1.250 | 0.470 | 0.570 | NA | 0.090 |
| 80138S | 1/4" Drive 6 Pt. Mid Length Metric Socket 4mm | 0.460 | 0.270 | 1.250 | 0.080 | 0.310 | 0.760 | 0.030 |
| 80139S | 1/4" Drive 6 Pt. Mid Length Metric Socket 5mm | 0.460 | 0.310 | 1.250 | 0.120 | 0.310 | 0.760 | 0.030 |
| 80140S | 1/4" Drive 6 Pt. Mid Length Metric Socket 5.5mm | 0.460 | 0.340 | 1.250 | 0.140 | 0.470 | 0.760 | 0.030 |
| 80141S | 1/4" Drive 6 Pt. Mid Length Metric Socket 6mm | 0.460 | 0.360 | 1.250 | 0.160 | 0.510 | 0.760 | 0.030 |
| 80142S | 1/4" Drive 6 Pt. Mid Length Metric Socket 7mm | 0.460 | 0.410 | 1.250 | 0.200 | 0.510 | 0.760 | 0.030 |
| 80143S | 1/4" Drive 6 Pt. Mid Length Metric Socket 8mm | 0.460 | 0.460 | 1.250 | 0.240 | 0.530 | NA | 0.030 |
| 80144S | 1/4" Drive 6 Pt. Mid Length Metric Socket 9mm | 0.500 | 0.500 | 1.250 | 0.280 | 0.530 | NA | 0.040 |
| 80145S | 1/4" Drive 6 Pt. Mid Length Metric Socket 10mm | 0.570 | 0.570 | 1.250 | 0.310 | 0.530 | NA | 0.050 |
| 80146S | 1/4" Drive 6 Pt. Mid Length Metric Socket 11mm | 0.550 | 0.550 | 1.250 | 0.350 | 0.570 | NA | 0.060 |
| 80147S | 1/4" Drive 6 Pt. Mid Length Metric Socket 12mm | 0.590 | 0.590 | 1.250 | 0.390 | 0.570 | NA | 0.060 |
| 80148S | 1/4" Drive 6 Pt. Mid Length Metric Socket 13mm | 0.630 | 0.630 | 1.250 | 0.430 | 0.570 | NA | 0.070 |
| 80149S | 1/4" Drive 6 Pt. Mid Length Metric Socket 14mm | 0.710 | 0.710 | 1.250 | 0.470 | 0.570 | NA | 0.100 |
| 80150S | 1/4" Drive 6 Pt. Mid Length Metric Socket 15mm | 0.790 | 0.790 | 1.250 | 0.510 | 0.570 | NA | 0.120 |
| 80363S | 3/8" Drive 6 Pt. Mid Length SAE Socket 1/4" | 0.660 | 0.390 | 1.810 | 0.180 | 0.350 | 1.020 | 0.070 |
| 80364S | 3/8" Drive 6 Pt. Mid Length SAE Socket 5/16" | 0.660 | 0.460 | 1.810 | 0.200 | 0.510 | 1.020 | 0.070 |
| 80365S | 3/8" Drive 6 Pt. Mid Length SAE Socket 3/8" | 0.660 | 0.540 | 1.810 | 0.300 | 0.630 | 1.020 | 0.080 |
| 80366S | 3/8" Drive 6 Pt. Mid Length SAE Socket 7/16" | 0.660 | 0.620 | 1.810 | 0.350 | 0.630 | 1.020 | 0.090 |
| 80367S | 3/8" Drive 6 Pt. Mid Length SAE Socket 1/2" | 0.740 | 0.740 | 1.810 | 0.430 | 0.830 | NA | 0.120 |
| 80368S | 3/8" Drive 6 Pt. Mid Length SAE Socket 9/16" | 0.780 | 0.780 | 1.810 | 0.470 | 0.830 | NA | 0.130 |
| 80369S | 3/8" Drive 6 Pt. Mid Length SAE Socket 5/8" | 0.810 | 0.860 | 1.810 | 0.550 | 0.830 | NA | 0.160 |
| 80370S | 3/8" Drive 6 Pt. Mid Length SAE Socket 11/16" | 0.870 | 0.940 | 1.810 | 0.590 | 0.830 | NA | 0.190 |
| 80371S | 3/8" Drive 6 Pt. Mid Length SAE Socket 3/4" | 0.940 | 1.020 | 1.810 | 0.670 | 0.830 | NA | 0.220 |
| 80372S | 3/8" Drive 6 Pt. Mid Length SAE Socket 13/16" | 0.980 | 1.090 | 1.810 | 0.750 | 1.020 | NA | 0.250 |
| 80373S | 3/8" Drive 6 Pt. Mid Length SAE Socket 7/8" | 1.080 | 1.170 | 1.810 | 0.790 | 1.020 | NA | 0.290 |
| 80388S | 3/8" Drive 6 Pt. Mid Length Metric Socket 6mm | 0.660 | 0.390 | 1.810 | 0.160 | 0.350 | 1.020 | 0.070 |
| 80389S | 3/8" Drive 6 Pt. Mid Length Metric Socket 7mm | 0.660 | 0.420 | 1.810 | 0.200 | 0.350 | 1.020 | 0.080 |
| 80390S | 3/8" Drive 6 Pt. Mid Length Metric Socket 8mm | 0.660 | 0.470 | 1.810 | 0.240 | 0.590 | 1.020 | 0.070 |
| 80391S | 3/8" Drive 6 Pt. Mid Length Metric Socket 9mm | 0.660 | 0.520 | 1.810 | 0.280 | 0.590 | 1.020 | 0.080 |
| 80392S | 3/8" Drive 6 Pt. Mid Length Metric Socket 10mm | 0.660 | 0.560 | 1.810 | 0.310 | 0.630 | 1.020 | 0.080 |
| 80393S | 3/8" Drive 6 Pt. Mid Length Metric Socket 11mm | 0.660 | 0.620 | 1.810 | 0.350 | 0.630 | 1.020 | 0.080 |
| 80394S | 3/8" Drive 6 Pt. Mid Length Metric Socket 12mm | 0.700 | 0.700 | 1.810 | 0.390 | 0.830 | NA | 0.110 |
| 80395S | 3/8" Drive 6 Pt. Mid Length Metric Socket 13mm | 0.740 | 0.740 | 1.810 | 0.430 | 0.830 | NA | 0.120 |
| 80396S | 3/8" Drive 6 Pt. Mid Length Metric Socket 14mm | 0.780 | 0.780 | 1.810 | 0.470 | 0.830 | NA | 0.130 |
| 80397S | 3/8" Drive 6 Pt. Mid Length Metric Socket 15mm | 0.810 | 0.810 | 1.810 | 0.510 | 0.830 | NA | 0.160 |
| 80398S | 3/8" Drive 6 Pt. Mid Length Metric Socket 16mm | 0.810 | 0.810 | 1.810 | 0.550 | 0.830 | NA | 0.150 |
| 80399S | 3/8" Drive 6 Pt. Mid Length Metric Socket 17mm | 0.870 | 0.870 | 1.810 | 0.590 | 0.830 | NA | 0.190 |
| 80400S | 3/8" Drive 6 Pt. Mid Length Metric Socket 18mm | 0.910 | 0.910 | 1.810 | 0.630 | 0.830 | NA | 0.210 |
| 80401S | 3/8" Drive 6 Pt. Mid Length Metric Socket 19mm | 0.940 | 0.940 | 1.810 | 0.670 | 0.830 | NA | 0.220 |

Mid-Length Sockets - Sets



80304S



80305S



80554S



80555S

| PART NO. | PRODUCT NAME | CONTENTS |
|----------|--|---|
| 80304S | 13 Pc. 1/4" Drive 6 Pt. Mid Length Socket Set Metric | 4, 5, 5.5, 6, 7, 8, 9, 10, 11, 12, 13, 14, 15 mm |
| 80305S | 10 Pc. 1/4" Drive 6 Pt. Mid Length Socket Set SAE | 3/16", 7/32", 1/4", 9/32", 5/16", 11/32", 3/8", 7/16", 1/2", 9/16" |
| 80554S | 14 Pc. 3/8" Drive 6 Pt. Mid Length Socket Set Metric | 6, 7, 8, 9, 10, 11, 12, 13, 14, 15, 16, 17, 18, 19 mm |
| 80555S | 11 Pc. 3/8" Drive 6 Pt. Mid Length Socket Set SAE | 1/4", 5/16", 3/8", 7/16", 1/2", 9/16", 5/8", 11/16", 3/4", 13/16", 7/8" |